



# 4800

hand-drawn

for light and medium-weight curtains

**Stable rail with elegant appearance**

# 4800



## hand-drawn

for light and medium-weight curtains

## Stable & elegant

The Qurails 4800 is a very stable rail because of its shape. It emanates elegance and simplicity. The track can be easily mounted on a wall or ceiling in various ways. A very popular track that can be used in a wide variety of situations, such as private homes, but also in office buildings and in the care sector.

- The ideal track for sheers, medium-heavy or heavy curtains.
- Easy to bend and exceptional quality.
- Can be forward or reverse bent in different radii.
- Compatible with the Qurails Flow System for regularly pleated curtains.
- Silent and smooth running, also round bends.



### Standard colours



High quality, wear-resistant coating, highly colourfast, UV-resistant.  
Other RAL colours & special coatings on request.

### Features

|                 |                                |
|-----------------|--------------------------------|
| Material:       | aluminium                      |
| Colour:         | white, natural anodised, black |
| Dimensions:     | 21 x 13 mm                     |
| Weight profile: | 231 gr/m                       |
| Mounting:       | wall or ceiling                |

## Profile/glider specifications

### Aluminium profile:

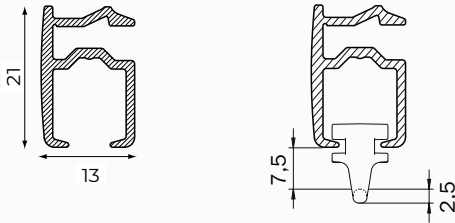

### Colours with RAL code and lengths (m):

|         | RAL  | 4 | 5 | 6 | 7 |
|---------|------|---|---|---|---|
| white   | 9010 | • | • | • | • |
| natural |      |   |   | • |   |
| black   | 9005 |   |   | • |   |

### Mounting surface:

- wood
- masonry/concrete

### Bracket type:

- ceiling bracket
- wall bracket
- spacer bracket

### Bending:

| bending radius | bending tool |
|----------------|--------------|
| R 10 cm        | 1015         |
| R 15 cm        | 1015         |
| R > 100 cm     | 1018         |

R 10 cm

R > 100 cm

## Flow

The Qurails Flow System keeps pleats in curtains consistent. It can be used with small and wide channel tracks and, because of the broad assortment of components, it can be integrated in hand-drawn, cord-pulled and electrically operated systems.

The Flow System can also be used with curved curtain tracks. For further information, [see the Flow product data sheet](#).

## Specification guide

### Material

- Aluminium EN AW-6060-T66.
- Anodised in accordance with the Qualanod standard.
- Powder coated in accordance with the Qualicoat standard.

## Mounting

Wall mounting  
with wall bracket 5351

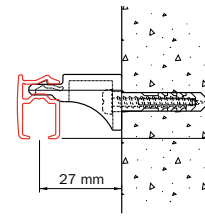

Ceiling mounting  
with wall bracket 5350

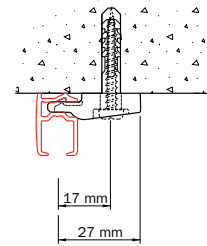

Ceiling mounting with double bracket 2216  
and ceiling support 5350

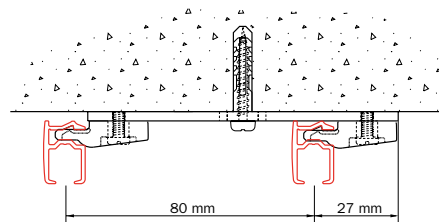

Method for  
uncoupling wall  
bracket 5351 and rail  
4800

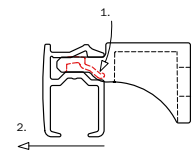

Mounting with  
extension brackets  
2015, 2018 or 2019 in  
combination with  
ceiling bracket 5350

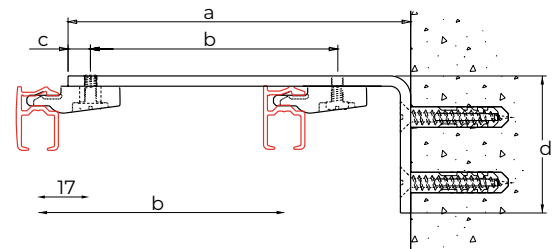

Detail front view  
of extension bracket

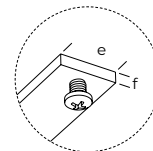

| [mm]      | a   | b       | c   | d  | e  | f |
|-----------|-----|---------|-----|----|----|---|
| 2015-05   | 50  | -       | 6.5 | 40 | 16 | 3 |
| 2015-07.5 | 75  | 47      | 6.5 | 40 | 16 | 3 |
| 2015-10   | 100 | 72      | 6.5 | 40 | 16 | 3 |
| 2015-15   | 150 | 72      | 6.5 | 40 | 16 | 3 |
| 2018-15   | 150 | 57 / 57 | 6   | 80 | 20 | 4 |
| 2019-20   | 200 | 80      | 6.5 | 60 | 20 | 4 |
| 2019-25   | 250 | 80      | 6.5 | 60 | 20 | 4 |
| 2019-30   | 300 | 80      | 6.5 | 60 | 20 | 4 |

## Application example

Mounting to suspended ceiling by means of grid bracket, this application is not suitable for heavy curtains.

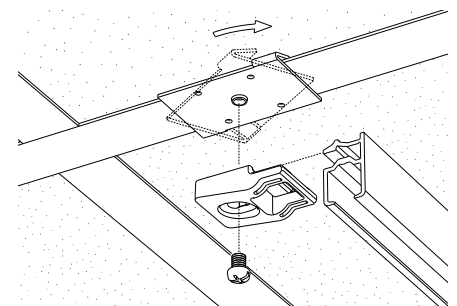

## Mounting guideline



The distance between the brackets can vary depending on the following factors: the mounting surface (wood, concrete or plaster), the weight of the curtains and the curtain fabric production method, the specific application and the system usage intensity. General advice: with the curtains open, place additional brackets where the pleats bunch together. Also place additional brackets before and after bends.





## Standard parts

### Curtain transport



4001  
end stop  
white / grey / black

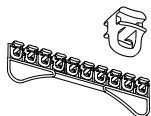

4010  
glider  
white / grey / black

### Mounting



5350  
ceiling bracket  
white / black

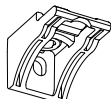

5351  
wall bracket  
white

### Accessories



4853  
end cap  
white / grey / black



2152  
connecting bridge  
natural

## Optional parts

### Curtain transport

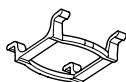

2004  
brake glider  
white / grey / black



4001-M  
end stop metal  
with eye natural



4002-M  
end stop metal



4003  
spring stop plastic  
requires punch hole  
white



4007  
rotating glider white/  
grey / silver / black



4007-LRS  
rotating glider LRS  
grijs / rotating glider  
LRS red



4010-50  
glider white with  
plastic hook 2023



4012  
click-in glider white



4020  
heavy duty glider  
white / grey / black

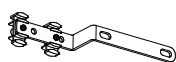

4074-1000  
carrier with overlap,  
a.o. for draw rod  
white / natural  
metallic / black

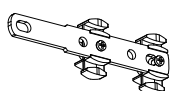

4075-1000  
carrier without  
overlap, a.o. for draw  
rod white / natural  
metallic / black



2020  
double hook  
white



2021-FL  
G-Hook  
white



2022  
curtain hook  
white



2023  
curtain hook  
white



2024-55  
adjustable sew  
in hook white  
55mm

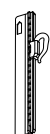

2024-95  
adjustable sew  
in hook white  
95mm

### Mounting

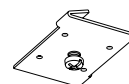

2050-SYST  
T-bar clip white for  
ceiling grid

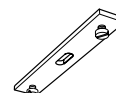

2216  
double bracket  
white / natural metallic  
/ black

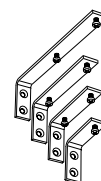

2015  
extension bracket  
5, 7.5, 10, 15 cm  
white / natural  
metallic / black

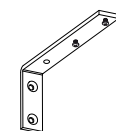

2018  
extension bracket  
heavy duty 15 cm  
white / natural metallic

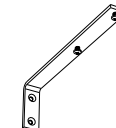

2019  
extension bracket heavy  
duty 20, 25, 30 cm  
white / natural metallic /  
zwart

### Accessories



4048-12MM  
corner  
connection



KVT-T1  
draw rod  
100, 125, 150, 200 or  
300 cm white / natural  
metallic / black /  
transparent

Technical specifications are subject to change without prior notice.

Copyright: Photography The Duke, Dré Wouters, The Art of Living magazine

# Qurails®

Open a new experience